



## 金屬化膜匣式電容器 METALIZED POLYESTER CAPACITOR

MEC are constructed with metalized Polyester film dielectric, copperplated lead, encapsulated in plastic case with epoxy resin sealed. They are suitable for filtering, by-pass, decoupling, coupling blocking, timing circuits and ideal for use in data processing, telecommunication equipments, industrial, automatic control system.

### FEATURES:

- Non-inductive construction.
- Self-healing property.
- High-moisture resistance.
- Good solderability.

### SPECIFICATION:

- OPERATING TEMPERATURE :  $-40^{\circ}\text{C} \sim +85^{\circ}\text{C}$
- CAPACITANCE RANGE :  $.01 \sim 10 \mu\text{F}$
- CAPACITANCE TOLERANCE :  $\pm 5\%$ (J),  
 $\pm 10\%$ (K)  
 $\pm 20\%$ (M)
- RATED VOLTAGE : 100VDC  
250VDC  
400VDC  
630VDC
- DISSIPATION FACTOR : 1.0 % MAX
- INSULATION RESISTANCE :  $> 15000\text{M}\Omega$   
( $C \leq .33\mu\text{F}$ )  
 $> 5000\text{M}\Omega$   
( $C > .33\mu\text{F}$ )

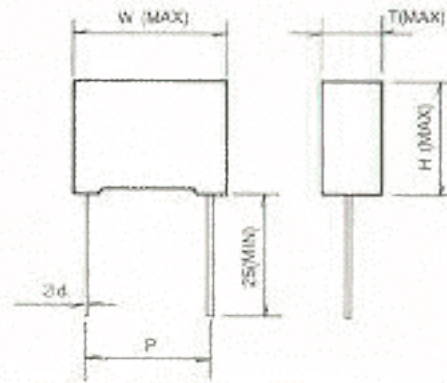
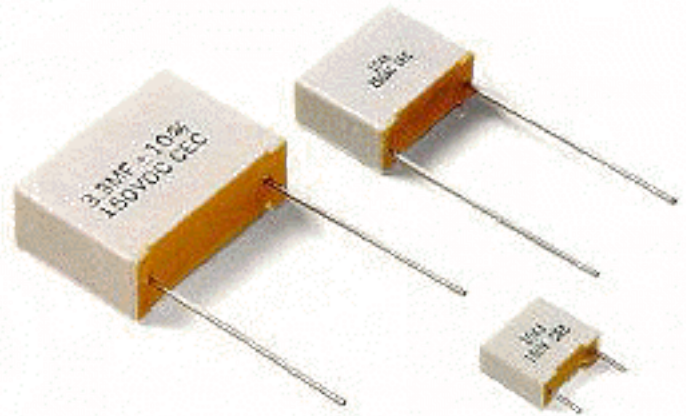

CAPACITANCE		100 V	250 V	400 V	630 V
SYMBOL	$\mu\text{F}$				
103	0.010	C1	C1	B1	C1
153	0.015			C1	C2
223	0.022				
333	0.033			C3	D2
473	0.047				
683	0.068			C3	D4
104	0.10				
154	0.15	C3	D2	E2	
224	0.22	C2	D1	D3	E3
334	0.33	C3	D2	D4	E3
474	0.47	D1	D3	E3	F1
684	0.68	D2	D4	E4	
105	1.0	D3	E1	F1	
155	1.5	D4	E4	F2	
225	2.2	E2	F1		
335	3.3	E4	F2		
475	4.7	F1			
685	6.8	F2			
106	10	F3			

TYPE / SIZE	W	H	T	P $\pm 1$	d
C1	13	9	4	10	0.6
C2	13	11	5	10	0.6
C3	13	12	6	10	0.6
D1	18	11	5	15	0.8
D2	18	12	6	15	0.8
D3	18	13.5	7.5	15	0.8
D4	18	14.5	8.5	15	0.8
E1	26.5	15	6	22.5	0.8
E2	26.5	16.5	7	22.5	0.8
E3	26.5	17.5	8.5	22.5	0.8
E4	26.5	19	10	22.5	0.8
F1	32	20	11	27.5	0.8
F2	32	22	13	27.5	0.8
F3	32	25	14	27.5	0.8